

BETHANY+VILLAGE

THE ART OF LIVING

THE COTTAGES • SUNFLOWER TERRACE • BETHANY HOME



At Bethany Village, we believe seniors should be empowered creatively, spiritually, and emotionally to do what they do best. Where others see challenges, we see potential. Where others see loss or decline, we see opportunity and capacity.

Through tapping into the talents of our residents, the rich arts and cultural life in Lindsborg, and inspiration from our Creator, we engage our community of seniors with creative activities, lifelong learning, and intergenerational opportunities—as well as instill a healthy sense of self-fulfillment, value, and friendship. Whether you're a tinkerer, crafter, gardener, musician, quilter, or simply one who appreciates the world of creativity, Bethany Village's "art of living" philosophy helps you make your golden years as healthy and dynamic as possible.

WE BELIEVE

- People aren't content to simply live longer— we want to age well
- Seniors should be able to take part in their favorite activities
- Creative arts benefit body, mind, and spirit—and offer opportunities for connection with others
- Using our creative gifts helps us live in and share God's love
- Our organization thrives when our staff is encouraged to be imaginative
- Creativity takes skill and practice, especially the art of care
- Creative living should be inclusive of all people, no matter the ability
- Creativity—and the "art of living" philosophy—is built on profound respect for each other

Supporting you to live your purpose through your own unique creative expression

- Imaginative
- Inspirational / encouraging
- Warm / approachable
- Skillful
- Inclusive

Bethany Village

The Bethany Home Association of Lindsborg, Kansas is first and foremost a Christian Home with a Christ centered atmosphere. The basic philosophy of Bethany Home is to continue the Christian Ministry of caring as done by our Lord and Master, Jesus Christ.

MISSION STATEMENT

Celebrating life's journey together in God's love.

VISION STATEMENT

Bethany Home is a vibrant, inclusive community where individuals receive the support needed to thrive and reach the highest level of independence attainable in a compassionate Christian environment. Highly trained, caring professionals provide peace of mind through thoughtful, personalized service and care, embracing innovation, forward thinking stewardship, and market-leading practices.

APPLICATION POLICY

An application for admission to The Cottages Independent Living, Sunflower Terrace Assisted Living and/or Bethany Home must be completed and returned to Bethany Village, accompanied by a **\$35.00 per person** non-refundable check. The applicant is encouraged to have a personal meeting and/or tour of the facilities. The Admissions Committee will review the application, with priority placement according to level of need or in order of the date on the application.

ADMISSIONS POLICY

An admission fee of \$160 will be charged upon admission to assisted living or \$375 to long-term care to cover costs for individual record and room preparation.

Once accepted for admission to assisted living or long-term care, residents and/or their families may request a face to face meeting prior to the admission date. Payments for room, board and personal care begin on the date of admission and are payable one month in advance. The payment period runs on a calendar month.

Should the resident be discharged and return to the facility within 12 months, this fee will not be charged again. If the resident is discharged and returns to the facility after 12 months, an admission fee will apply.

Admission fees will not be charged due to a change in the resident's level of care. For example: A resident moving from Sunflower Terrace assisted living to Bethany Home long-term healthcare will not be charged another admission fee.

BETHANY+VILLAGE

THE ART OF LIVING

CONTACT INFORMATION



THE COTTAGES

321 N. Chestnut | Lindsborg, KS

785.227.2334

mspohn@bethanyhome.com



SUNFLOWER TERRACE

821 E. Swensson | Lindsborg, KS

785.227.8331

mhancock@bethanyhome.com



BETHANY HOME

321 N. Chestnut | Lindsborg, KS

785.227.2334

marketing@bethanyhome.com

Empowering seniors
creatively, intellectually,
and emotionally to do
what they do best.

BETHANY+VILLAGE

785-227-2334

Ext.

Kris Erickson

CEO

111

Melissa Brumbaugh

Administrator

195

Jamie Priddy

Dietary Manager

121

Bethany Home Kitchen

Dining Reservations

785-227-2846

Linda Call/Marcus Vinyard

Activities

123

Delwin Koons

Maintenance

125

Andrea Johnson

Human Resources

126

Dr. Mandy Todd

Chaplain

133

Jennifer Cantrell

Marketing Director

142

Melaney Seehafer

Social Services, Admissions

145

Marilyn Spohn

Billing/Independent Living

146

Lynn Andres, RN

Director of Nursing

144

Wendy Johnson

Skilled Services

182

Maggie Hancock, RN

Sunflower Terrace Operator

200

All prices and rates are subject to an annual increase
effective October 1



SUNFLOWER TERRACE

Daily activities like housekeeping, meal planning, cooking, and home maintenance become more difficult with time. **Sunflower Terrace Assisted Living** can remove daily burdens so you can enjoy doing the things you want to do!

Sunflower Terrace Assisted Living is the ideal solution for those who need some attendant care or supervision but still have the ability to maintain their own independence. Spacious and bright apartments are handicap accessible and offer private bedrooms and bathroom, modern kitchenettes with microwave, refrigerator and granite countertops.



Amenities & Options

Monthly Rent Includes:

- Private apartment & bathroom with zero-entry walk-in shower
- Kitchenette with microwave & refrigerator
- Ample closets & storage
- All utilities (Cable TV & phone service extra*)
- Emergency response system call lights in bedrooms & bathrooms
- Transportation services*

On site storm shelter/ safe room

*Additional fees may apply for some services

- Professional caring staff
- 24 hour access to:
 - Certified Medication Aides
 - Licensed Nurses
- Personalized Care Plans
- Daily programs, events & outings*
- Wireless Internet
- Smoke Free Campus (Smoking is prohibited on all Bethany Village properties)

Services available for additional fees:

- Personal care assistance
- Weekly housekeeping & linen services
- Ongoing medication management & health monitoring
- On-site Physical, Speech, & Occupational Therapy
- Nutritious daily meals served restaurant style with flexible menu options and between meal snacks
- On-site Exercise room
- Salon Services



821 E. Swensson | Lindsborg, KS 67456
Phone 785-227-8331 | Fax 785-227-8332
www.BethanyVillageKS.com

SUNFLOWER TERRACE

STUDIO APARTMENT

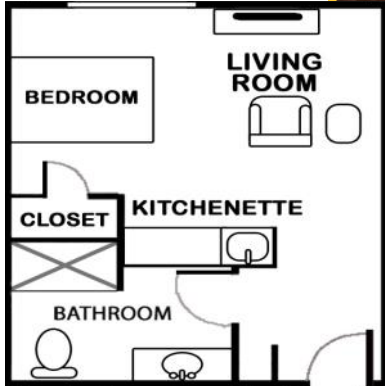

18'6" X 24'
450 Sq. Feet

Full bath,
ample storage,
TV, wireless internet

Base Rate
\$2,188*

1 BEDROOM APARTMENT



22'6" X 24'
550 Sq. Feet

Bedroom, separate
living and dining space,
Kitchenette, Full bath, TV,
wireless internet

Base Rate
\$2,526*



2 BEDROOM APARTMENT

41' X 24'
1000 Sq. Feet

2 Bedrooms, separate living and dining space,
Kitchenette, 2 Full baths (Legacy only), TV,
wireless internet

Base Rate
\$3,722*

Additional \$54.00 per day/ \$1,642.50* per month for 2nd person; Fees for services may apply

*Rates shown are estimated on a 30 day month; Actual billing based on a daily rate

For a virtual tour

Visit <https://SunflowerTerrace.com>

Maggie Hancock, RN
821 E. Swensson | Lindsborg, KS 67456
Phone 785-227-8331 | Fax 785-227-8332
www.BethanyVillageKS.com